

SERVICE



BULLETIN

SB #: F151 (Revision B)**BRANDS:****DATE:** MARCH 2020**TO:** ALL AUTHORIZED FERRIS DEALERS**SUBJECT:** FERRIS SRS Z3X PARKING BRAKE ADJUSTMENT
PROCEDURE AND OPERATOR'S MANUAL CORRECTION**REVISION:** The information in this revised bulletin supercedes information on any previous version of this bulletin.

- ☐ - ACTION REQUIRED
- ☐ - IF ENCOUNTERED
- ☒ - INFORMATION ONLY

Brand	Model Numbers	Serial Number Range	Description
Ferris	5901691, 5901692, 5901693, 5901694, 5901784, 5901789, 5901809, 5901951, 5901953, 5901955, 5901957, 5902071, 5902096, 5902123 & 5902170	4002374868 and below	SRSZ3X Series Zero-Turn Riding Mower

DESCRIPTION

Ferris has identified that the parking brake on some SRS Z3X's were not set correctly during manufacturing. The procedure detailed in some operator's manuals has also been identified as not being correct. Follow the below corrective actioning when checking the transaxle parking brake setting.

CORRECTION PROCEDURE

- At the next regular service, the parking brake setting on the transaxle should be checked.
- Anytime the parking brake needs to be adjusted please use the following adjustment procedure or the procedure detailed in the an operator's manual at revision D or higher. The revision level (**A, Figure 1**) is located in the bottom right hand corner on the front cover of the manual. All manuals at revision D or higher and any manual downloaded off of the Power Portal or ferrismowers.com after 12/05/2019 are correct.

Parking Brake Adjustment

Prior to adjusting the parking brake the neutral lockout and tracking adjustment procedures must be checked and adjusted correctly. See *Neutral Lockout* and *Tracking Adjustment* as detailed in the Operator's Manual.

- Park the unit on a flat, level surface such as a concrete floor. Disengage the PTO, engage the parking brake, turn the ignition to OFF, and remove the ignition key.

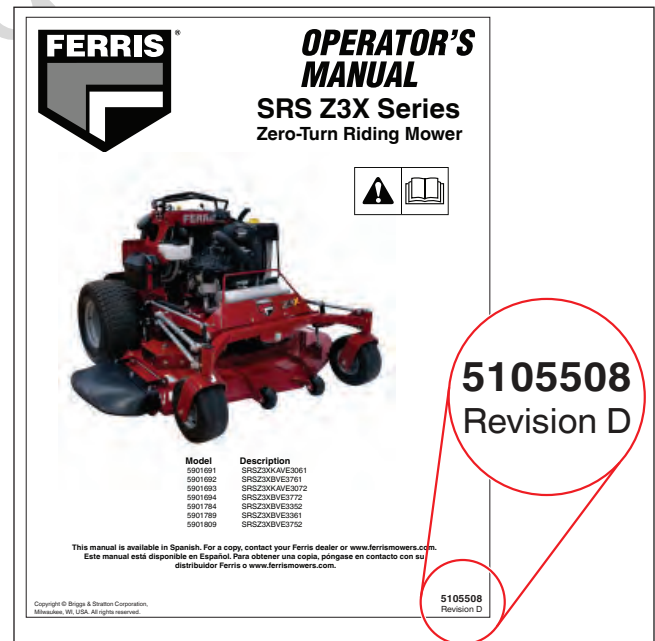
**Figure 1. Revision Location on Cover**

2. Remove the foot guard (**A**, **Figure 2**) and the hardware that retains it from the back of the unit.
3. Locate the two parking brake springs (**A**, **Figure 3**) below the engine deck by the unit's transaxles.
4. Measure the distance from the end of the spring to the bottom face of the flat washer (**B**). This measurement is identified as "**C**" in **Figure 3**. The measurement should equal 2-3/4" (7,0 cm). If not, position the adjustment nut (**D**) until the measurement equals 2-3/4" (7,0 cm).
5. Measure the distance (**E**) between the top of the lower parking brake bracket (**F**) and the bottom edge of the set collar (**G**). The measurement should be 3/16" (0,48 cm). If not, position the set collar until the measurement equals 3/16" (0,48 cm).
6. Repeat this process for the parking brake spring on the other transaxle.
7. Chock the front wheels of the unit to prevent the unit from moving and then release the parking brake.
8. Inspect the control arm spring (**A**, **Figure 4**) on the transaxles. When the parking brake is released the parking brake lever post (**B**) will come into alignment with the stationary housing post (**C**). The two posts (**D**) of the spring will rest on the stationary post.
9. Put the foot guard back onto the unit using the hardware that previously retained it.

Note: If this does not correct your braking problem, see your authorized dealer

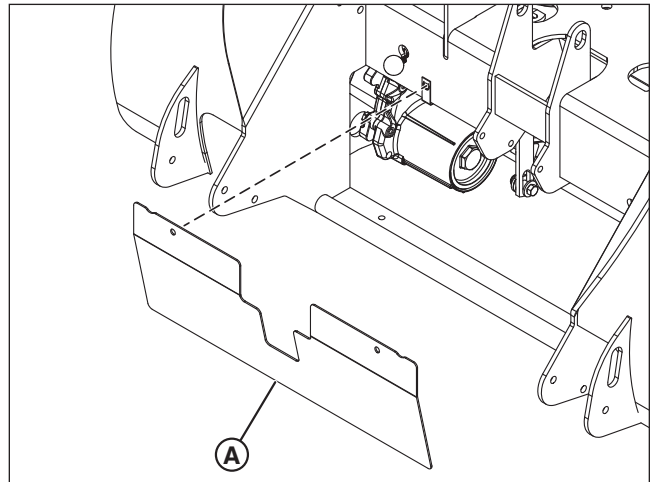

Figure 2. Remove the Foot Guard

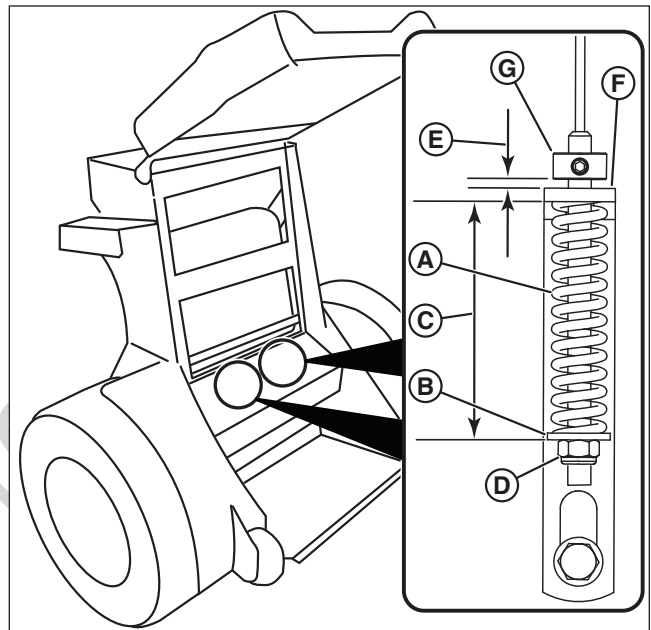

Figure 3. Parking Brake Adjustment

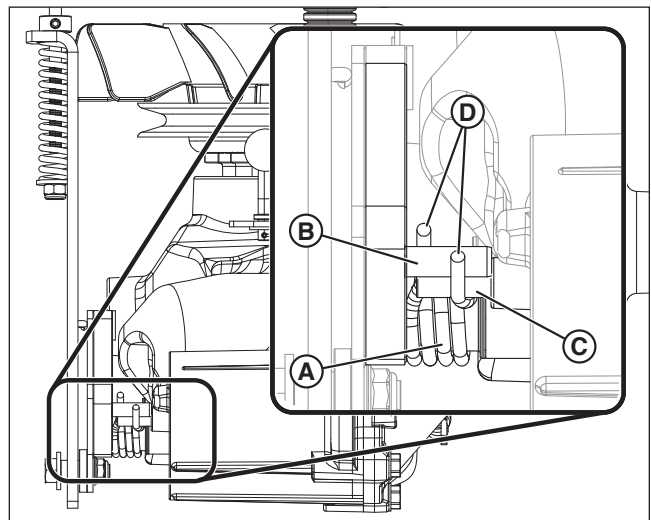

Figure 4. Control Arm Adjustment

WARRANTY:

Warranty coverage of this bulletin coincides with the unit's standard warranty period.

File for warranty reimbursement using e-Claim at www.ThePowerPortal.com. Use the values listed below when filling out the claim. The information in the "Brand" block indicates which tab the claim should be filed under. *Note: File only one unit per claim form.*

Brand	Ferris
Control/Evaluation Number	F151
Customer Experience Category (Symptoms)	Other Product Performance
Product Category	COM Commercial Equipment
Key Part Identification Category	Wheel/Tire Group
Key Part Identification Code	Parking Brake Assy
Condition Code	SP Special Program
Tech Comments	F151
Pick-Up & Delivery	N/A
Labor Required (1/4 hours):	0.5 hours (30 minutes)
Repair Parts Used	N/A

BRIGGS & STRATTON CORPORATION
Distribution Sales & Customer Support